

ELEV 23

NZAA

TOWER: 118.7 120.95

DELIVERY: 128.2

GROUND: 121.9

APRON: 123.0

ATIS: 127.8 127.0

AUCKLAND

INTERNATIONAL APRON – RWY 05R/23L

RESTRICTIONS AND HAZARDS

- All aircraft ground movements confined to RWY, TWY and apron areas.
- A vehicular traffic roadway is marked on the apron by broken red and white lines and highlighted by red reflectors.
- TWY B4, B5 and B7 are not AVBL to Boeing 777-300, Airbus A340-500 and A340-600 ACFT. All other code E ACFT are advised to exercise caution and use judgemental over-steer.
- TWY L north of mid-point not visible from TWR. Under camera surveillance.
- Wide body ACFT turning into Stands 15 and 16 from the west are to use minimum power.
- Wide body ACFT turning into Stands 82 and 83 are to use minimum power.

Limitations/general information during code F aircraft operations

- When a code F aircraft is on TWY A between B2 and J, code E aircraft can use TWY BRAVO.
- Code F aircraft are not allowed on TWY A between TWY B6 and J and on TWY B between TWY B6 and J at the same time.
- When a code F aircraft is on TWY B between TWY B6 and J, TWY D and Stand 84 are restricted to MAX code C aircraft.
- When a code F aircraft is on Stand 84, TWY B between D4 and D8 will be restricted to maximum code D aircraft.
- Wide body aircraft cannot use D8 and TWY K between aircraft Stands 7 and 10 simultaneously.
- Only 738 and A320 type aircraft or smaller can hold on D8 while wide body aircraft taxi on TWY K between Stands 7 and 10.

- TWY D8 Northbound:** Aircraft must hold with pilot aligned with STOP arrow by day or two alignment stop LIGHTS by night to ensure clearance from aircraft using TWY K.
- TWY D8 Southbound:** Aircraft must hold with pilot aligned with the STOP arrow by day or two alignment stop LIGHTS by night to ensure clearance from aircraft using TWY B.
- TWY M southbound aircraft required to hold short of TWY A, must do so with the pilot aligned with the STOP arrow by day or two alignment stop lights, on the left side of the aircraft by night.
- TWY D3 limited to aircraft under 60,000 kg MAUW. Closed to aircraft over 36 m wingspan.
- Code F aircraft assigned Stand 83 cannot taxi on TWY J north of aircraft Stand 6.

Apron information service, call sign "AUCKLAND APRON" is provided by aerodrome operator

Refer to Ground Movements chart for taxiway details:
 – RWY 05R/23L OPERATIONS (WHITE)
 – RWY 05R/23L WIP WEST (YELLOW)
 – RWY 05R/23L WIP EAST (YELLOW)

AAAPRONINTL-R

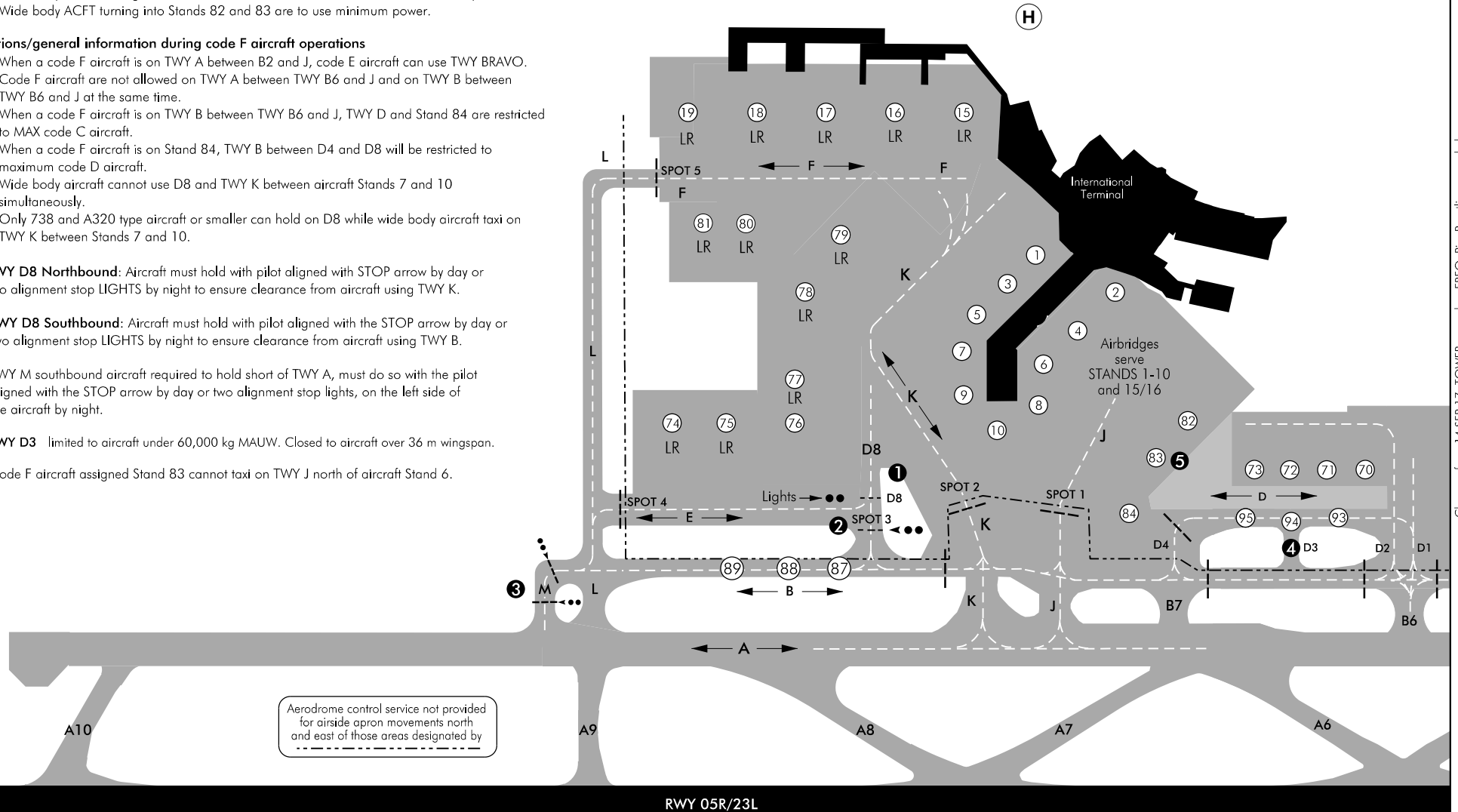

Changes from 14 SEP 17: TOWER secondary FREQ, Pier B outline amended.

Effective: 9 NOV 17

RESTRICTIONS AND HAZARDS

- All aircraft ground movements confined to RWY, TWY and apron areas.
- A vehicular traffic roadway is marked on the apron by broken red and white lines and highlighted by red reflectors.
- **TWY B** between TWY B1 and TWY B2 not visible from TWR. Under camera surveillance.
- **TWY B4, B5 and B7** are not AVBL to Boeing 777-300, Airbus A340-500 and A340-600 ACFT.
- **TWY C2, TWY C3** and centreline of apron limited to aircraft not exceeding 39 m wingspan. Elsewhere on apron limited to aircraft not exceeding 14.1 m wingspan.
- Access to stands 70-73 is via D2.

Limitations during code F aircraft operations

- When a code F aircraft is on TWY A between B2 and J, code E aircraft can use TWY BRAVO.
- Code F aircraft are not allowed on TWY A between TWY B6 and J and on TWY B between TWY B6 and J at the same time.
- When a code F aircraft is on TWY B between TWY B6 and J, TWY D and Stand 84 are restricted to max code D aircraft.

Domestic Stand Restrictions:

- Stand 35 available to ATR or Q300 when Stands 34 and 36 are vacant.
- Stand 41 available only when Stands 39 and 42 are vacant.

- 1** TWY C1 limited to aircraft up to 66,000 kg MAUW.
- 2** TWY C5 limited to aircraft of less than 36 m wingspan.
- 3** TWY C5 helicopter operations not permitted.
- 4** TWY D1 and D2 limited to aircraft of less than 36 m wingspan except that TWY D1 can be used by all aircraft entering or leaving TWY D, only when TWY D2 is unused.
- 5** TWY D3 limited to aircraft under 60,000 kg MAUW. Closed to aircraft over 36 m wingspan.

Refer to Ground Movements chart for taxiway details:
 – RWY 05R/23L OPERATIONS (WHITE)
 – RWY 05R/23L WIP WEST (YELLOW)
 – RWY 05R/23L WIP EAST (YELLOW)

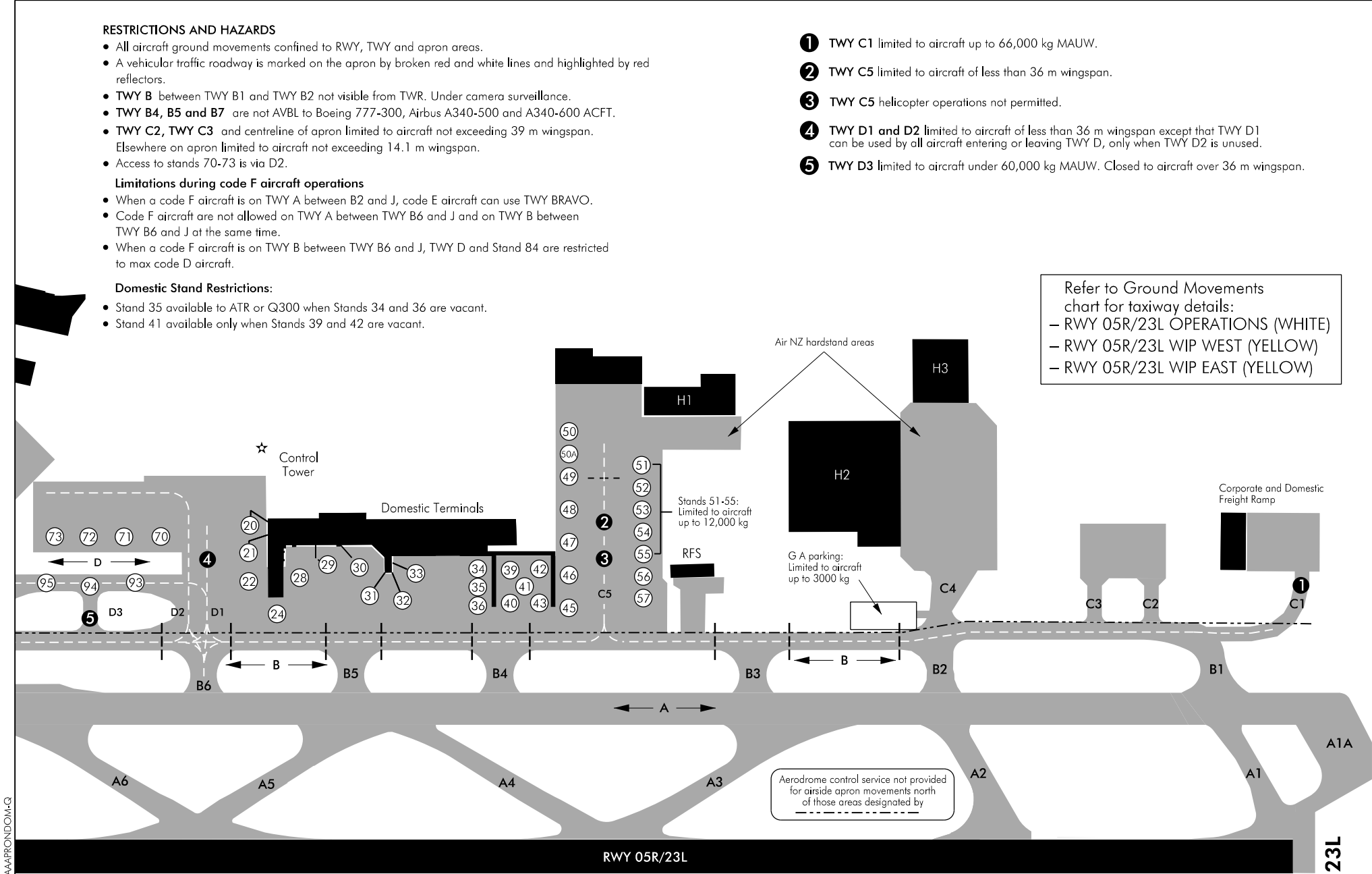

Changes from 25 MAY 17: TOWER secondary FREQ.