

ELEV 100

NZOM

NON-CERTIFICATED

**OMAKA****AERODROME**

WOODBOURNE TOWER: 122.8 118.1

WOODBOURNE ATIS: 126.05

UNATTENDED: 122.8

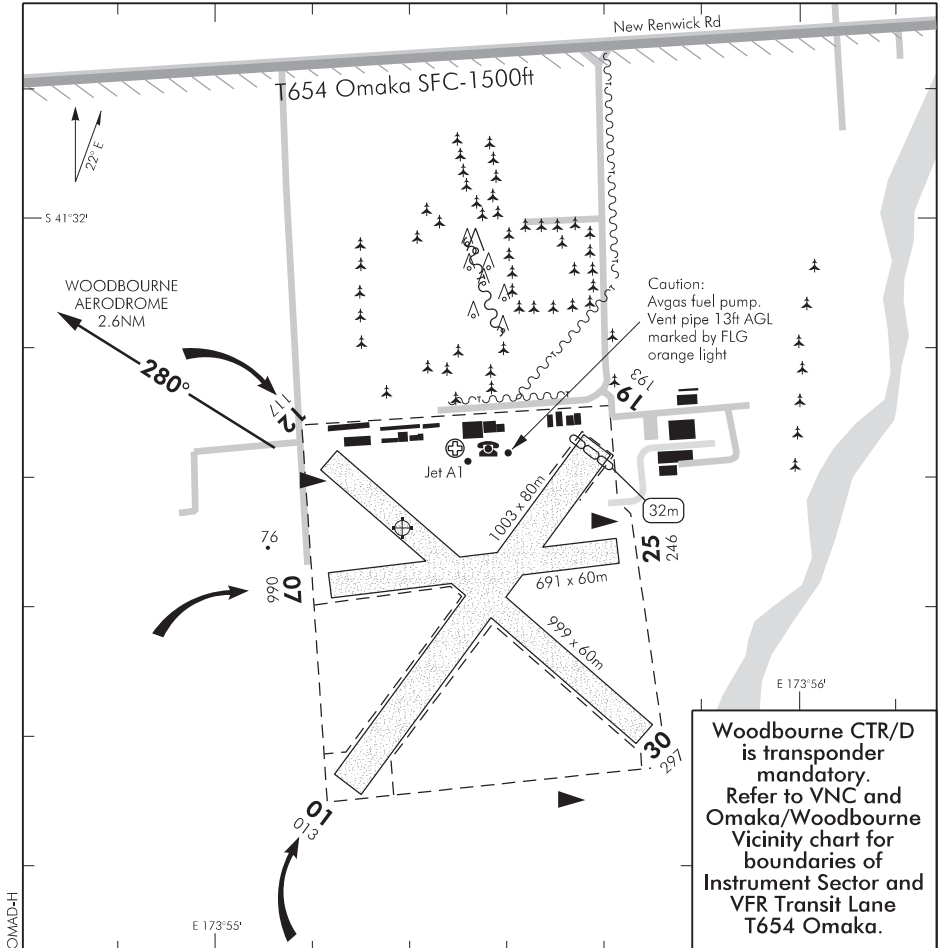

1. Circuit: RWY 30, 25, 19 — Left hand  
RWY 01, 07, 12 — Right hand
2. Recommended circuit altitudes: all runways 1000 ft AMSL (if joining overhead, join at 1500 ft AMSL).
3. **REQUIREMENT:** Aircraft operating within the OMAKA circuit are to restrict their operations to within OMAKA VFR Transit Lane (T654, refer OMAKA/WOODBOURNE Vicinity chart) unless otherwise cleared by Woodbourne Tower. By night, when Woodbourne Tower is on watch, an ATC clearance is required for all operations.
4. **CAUTION:** OMAKA aerodrome is located 1.3 NM south of the Woodbourne RWY 06 departure track and RWY 24 final approach track. Pilots should operate the aircraft transponder mode A/C if fitted.
5. Gliding operations may take place particularly during weekends and public holidays.
6. Take-off and landing operations confined to promulgated runways, unless prior arrangements made with aerodrome operator.
7. **CAUTION:** Locally based operators may be using vectors other than published runways.

Effective: 29 MAY 14

S 41 32 24 E 173 55 19\*

© Civil Aviation Authority

**OMAKA**  
**AERODROME**

NZOM

**OPERATIONAL DATA****RWY**

| RWY      | SFC   | Strength     | Gp | Slope | ASDA | Take-off distance |      |      | LDG<br>DIST |
|----------|-------|--------------|----|-------|------|-------------------|------|------|-------------|
|          |       |              |    |       |      | 1:20              | 1:30 | 1:40 |             |
| 01<br>19 | Gr(f) | ESWL<br>9080 | 8  | Nil   | 1003 | 971<br>1003       |      |      | 1003<br>971 |
| 07<br>25 | Gr(f) | ESWL<br>9080 | 5  | Nil   | 691  | 691               |      |      | 691         |
| 12<br>30 | Gr(f) | ESWL<br>9080 | 8  | Nil   | 999  | 999               |      |      | 999         |

**LIGHTING**

Nil

**FACILITIES**

Fuel: Jet A1, Avgas 100, Swipecard  
Marlborough Aero Club, Tel (03) 578 5073

Briefing: Available from Woodbourne Tower

Limited repairs

**SUPPLEMENTARY**

Operator: Marlborough Aero Club (Inc), PO Box 73, Blenheim  
Tel (03) 578 5073 Fax (03) 578 1817

Available for general private use without the permission of the operator.

Commercial operators requiring regular use must contact the Marlborough Aero Club for permission.

\$10.00 per landing payable on the day in the Honesty Box or at the Flight Office.

If payment is not made on the day, an invoice for \$25.00 per landing will be sent from Marlborough Aero Club.

For Marlborough Aero Club members an annual landing fee option is available.

For any fee enquiries, please contact — [fly@marlboroughaeroclub.co.nz](mailto:fly@marlboroughaeroclub.co.nz)